

# 7PE S Tank

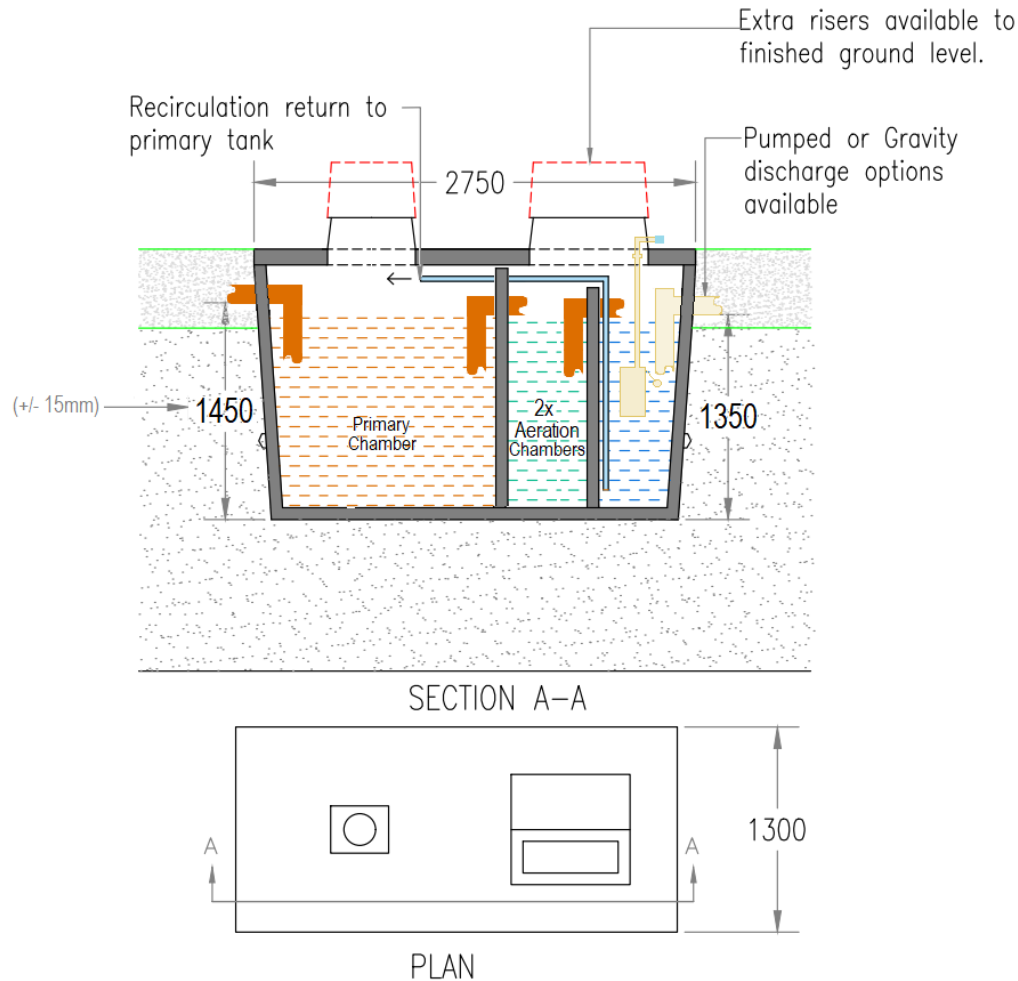

## Excavation

1.8m Wide

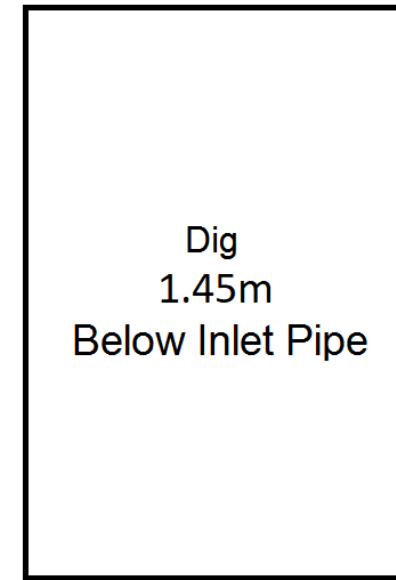

3m

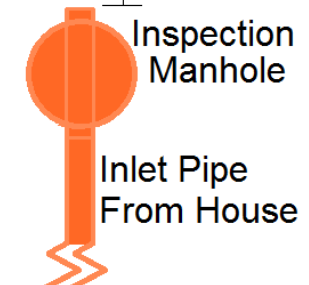

Moyglare Rd, Kilcock, Co Meath  
Ph: 01 6287300

Email: [info@sepcon.ie](mailto:info@sepcon.ie) Web: [www.sepcon.ie](http://www.sepcon.ie)

This drawing is Copyright to Ryan Civil Contracting Ltd t/a Sepcon

### Notes:

1. Do not scale from this drawing.
2. Drawings are for illustration purposes only and are subject to change.
3. Observe all safety regulations in regard to excavation and lifting requirements.
4. Never leave tank lids uncovered or unattended at any time.
5. Refer to the site specific report for details of loadings and further design information.
6. The cross section drawing above shows the tanks in a straight series configuration only. Consult us for excavation requirements in different tank configurations.
7. Ground conditions for tank installation to be approved by clients engineer.

Project Name: Sepcon BAF 7PE Sewage System - S Tank

Drawing Title: PE7 Sewage Treatment System - EN12566-3 & S.R.66:2015

Population: 7PE

Project No:

Client Ref:

Date: Mar20

Scale: N.T.S

Rev. no: S3

Dwg No: